

竞速遥控车系列



X-TEAM[®]
BRUSHLESS SYSTEM

遥控车模系列

R/C VEHICLE SERIES

INRUNNER BRUSHLESS MOTOR

X-TEAM遥控车模系列内转子无刷电机

XTI-12系列2磁极Mini-Z无感无刷电机

适用于: 1/32 1/28 1/26 1/24等各类蚊车

Available for class 130-1/132th or 1/124th scale vehicles
Number of stator slot: 2P
Sensored or sensorless: Sensorless
Diameter of shaft: $\Phi 1.0\text{mm}-\Phi 2.0\text{mm}$
Motor size: Diameter $\Phi 12$ / Length 22-30mm
Stator diameter: $\Phi 19\text{mm}$
Available winding: Delta/Star (Δ/Y)



产品特点:

- 专为迷你赛车设计的无感直流无刷电机
- 采用精密CNC加工马达外壳
- 超顺滑的高速转子设计
- 采用人工绕线方式, 保证高槽满率
- 2级软铁硼烧结磁钢
- 使用日本进口高转速轴承
- 0.2mm超薄进口砂钢片

型号	KV (rpm/v)	最大电压	最大功率	最大电流	空载电流	电阻 (Ω)	轴径x长度	马达尺寸	重量 (g)	安装孔尺寸 (mm)	螺丝孔深度
XTI-1222	11000	5V	80W	15A	0.28A	0.49	$\Phi 1.5 \times L6\text{mm}$	$\Phi 12 \times L22\text{mm}$	16g	$\Phi 8 \ 4 \times M2$	2.5mm
	8600	5.8V	80W	12A	0.20A	0.52	$\Phi 1.5 \times L6\text{mm}$	$\Phi 12 \times L22\text{mm}$	16g	$\Phi 8 \ 4 \times M2$	2.5mm
	7200	8.4V	80W	8A	0.15A	0.58	$\Phi 1.5 \times L6\text{mm}$	$\Phi 12 \times L22\text{mm}$	16g	$\Phi 8 \ 4 \times M2$	2.5mm
XTI-1230	9500	5.8V	90W	16A	0.30A	0.46	$\Phi 1.5 \times L6\text{mm}$	$\Phi 12 \times L30\text{mm}$	20g	$\Phi 8 \ 4 \times M2$	2.5mm
	6500	8.5V	90W	11A	0.22A	0.51	$\Phi 1.5 \times L6\text{mm}$	$\Phi 12 \times L30\text{mm}$	20g	$\Phi 8 \ 4 \times M2$	2.5mm
	4500	12.2V	90W	7.4A	0.16A	0.55	$\Phi 1.5 \times L6\text{mm}$	$\Phi 12 \times L30\text{mm}$	20g	$\Phi 8 \ 4 \times M2$	2.5mm

XTI-16系列2磁极Mini-Z无/有感无刷电机

适用于: 1/32 1/28 1/26 1/24等各类蚊车

Available for class 130-1/32th or 1/24th scale vehicles
Number of stator slot: 2P
Sensored or sensorless: Sensorless/Sensored
Diameter of shaft: $\Phi 1.0\text{mm}-\Phi 2.0\text{mm}$
Motor size: Diameter $\Phi 15$ / Length 22-30mm
Stator diameter: $\Phi 12\text{mm}$
Available winding: Delta/Star (Δ/Y)



产品特点:

- 专为迷你赛车设计的带霍尔传感器的直流无刷电机
- 采用精密CNC加工马达外壳
- 超顺滑的高速转子设计
- 采用人工绕线方式, 保证高槽满率
- 2级软铁硼烧结磁钢
- 使用日本进口高转速轴承

型号	KV (rpm/v)	最大电压	最大功率	最大电流	空载电流	电阻 (Ω)	轴径x长度	马达尺寸	重量 (g)	安装孔尺寸 (mm)	螺丝孔深度
XTI-1625	10500	5.8V	80W	14A	0.38A	0.32	$\Phi 2 \times L8\text{mm}$	$\Phi 15 \times 25\text{mm}$	12g	$\Phi 12 \ 8 \times M2$	3mm
	9500	6.0V	80W	12A	0.35A	0.41	$\Phi 2 \times L8\text{mm}$	$\Phi 15 \times 25\text{mm}$	12g	$\Phi 12 \ 8 \times M2$	3mm
	7500	8.0V	80W	11A	0.32A	0.48	$\Phi 2 \times L8\text{mm}$	$\Phi 15 \times 25\text{mm}$	12g	$\Phi 12 \ 8 \times M2$	3mm
	6900	8.4V	80W	10A	0.28A	0.52	$\Phi 2 \times L8\text{mm}$	$\Phi 15 \times 25\text{mm}$	12g	$\Phi 12 \ 8 \times M2$	3mm
	6000	8.4V	80W	9A	0.25A	0.55	$\Phi 2 \times L8\text{mm}$	$\Phi 15 \times 25\text{mm}$	12g	$\Phi 12 \ 8 \times M2$	3mm
	5500	8.4V	80W	10A	0.5A	0.28	$\Phi 2 \times L8\text{mm}$	$\Phi 15 \times 25\text{mm}$	12g	$\Phi 12 \ 8 \times M2$	3mm
	3500	8.4V	80W	9A	0.25A	0.64	$\Phi 2 \times L8\text{mm}$	$\Phi 15 \times 25\text{mm}$	12g	$\Phi 12 \ 8 \times M2$	3mm
XTI-1625Y	5300	7.4V	110W	15A	0.2A	0.54	$\Phi 2 \times L8\text{mm}$	$\Phi 15 \times 25\text{mm}$	18g	$\Phi 12 \ 8 \times M2$	3mm

INRUNNER BRUSHLESS MOTOR

X-TEAM遥控车模系列内转子无刷电机

XTI-20系列2磁极无感无刷电机

适用于：1/18越野、大脚遥控车，200~350mm船模

Available for class 170-1/18th or 1/16th scale vehicles
 Number of stator slot: 12G 4P
 Sensored or sensorless: Sensorless
 Diameter of shaft: $\Phi 2\text{mm}-\Phi 2.3\text{mm}$
 Motor size: Diameter $\Phi 20$ / Length 30~40mm
 Stator diameter: $\Phi 19\text{mm}$
 Available winding: Delta/Star (Δ/Y)

Technique:

- Hand-wound for maximum copper fill.
- Precision-balanced rotor will boost the efficiency and power performance of the motor.
- Nickel-plated sintered neodymium rotor for maximum motor acceleration, braking power and performance in high-temperature conditions.



型号	KV (rpm/v)	最大电压	最大功率	最大电流	空载电流	电阻 (Ω)	轴径x长度	马达尺寸	重量 (g)	安装孔尺寸 (mm)	螺丝孔深度
XTI-2030	7800	7.4V	350W	18A	2.2A	0.0325	$\Phi 2.3 \times L 15\text{mm}$	$\Phi 20 \times 30\text{mm}$	50g	$\Phi 16 \ 6 \times M2.5$	2.5mm
	7200	7.4V	350W	16A	1.8A	0.0385	$\Phi 2.3 \times L 15\text{mm}$	$\Phi 20 \times 30\text{mm}$	50g	$\Phi 16 \ 6 \times M2.5$	2.5mm
	6200	7.4V	350W	14A	1.4A	0.0502	$\Phi 2.3 \times L 15\text{mm}$	$\Phi 20 \times 30\text{mm}$	50g	$\Phi 16 \ 6 \times M2.5$	2.5mm
	5850	7.4V	350W	13A	1.3A	0.0582	$\Phi 2.3 \times L 15\text{mm}$	$\Phi 20 \times 30\text{mm}$	50g	$\Phi 16 \ 6 \times M2.5$	2.5mm
	5150	7.4V	350W	12A	1.2A	0.0733	$\Phi 2.3 \times L 15\text{mm}$	$\Phi 20 \times 30\text{mm}$	50g	$\Phi 16 \ 6 \times M2.5$	2.5mm
	4900	7.4V	350W	11V	1.2A	0.0841	$\Phi 2.3 \times L 15\text{mm}$	$\Phi 20 \times 30\text{mm}$	50g	$\Phi 16 \ 6 \times M2.5$	2.5mm
	4250	7.4V	350W	10A	0.8A	0.1108	$\Phi 2.3 \times L 15\text{mm}$	$\Phi 20 \times 30\text{mm}$	50g	$\Phi 16 \ 6 \times M2.5$	2.5mm
	4050	7.4V	350W	9A	0.6A	0.1202	$\Phi 2.3 \times L 15\text{mm}$	$\Phi 20 \times 30\text{mm}$	50g	$\Phi 16 \ 6 \times M2.5$	2.5mm
	3550	7.4V	350W	8A	0.6A	0.1535	$\Phi 2.3 \times L 15\text{mm}$	$\Phi 20 \times 30\text{mm}$	50g	$\Phi 16 \ 6 \times M2.5$	2.5mm
	3100	7.4V	350W	7A	0.4A	0.2018	$\Phi 2.3 \times L 15\text{mm}$	$\Phi 20 \times 30\text{mm}$	50g	$\Phi 16 \ 6 \times M2.5$	2.5mm
XTI-2040	4800	7.4V	380W	20A	1.5	0.0399	$\Phi 2.3 \times L 15\text{mm}$	$\Phi 20 \times 40\text{mm}$	60g	$\Phi 16 \ 6 \times M2.5$	2.5mm
	4450	7.4V	380W	18A	1.4	0.0468	$\Phi 2.3 \times L 15\text{mm}$	$\Phi 20 \times 40\text{mm}$	60g	$\Phi 16 \ 6 \times M2.5$	2.5mm
	3850	7.4V	380W	16A	0.9	0.0622	$\Phi 2.3 \times L 15\text{mm}$	$\Phi 20 \times 40\text{mm}$	60g	$\Phi 16 \ 6 \times M2.5$	2.5mm
	3400	7.4V	380W	14A	0.7	0.0794	$\Phi 2.3 \times L 15\text{mm}$	$\Phi 20 \times 40\text{mm}$	60g	$\Phi 16 \ 6 \times M2.5$	2.5mm
	3050	7.4V	380W	12A	0.6	0.0982	$\Phi 2.3 \times L 15\text{mm}$	$\Phi 20 \times 40\text{mm}$	60g	$\Phi 16 \ 6 \times M2.5$	2.5mm
	2750	7.4V	380W	11A	0.5	0.1204	$\Phi 2.3 \times L 15\text{mm}$	$\Phi 20 \times 40\text{mm}$	60g	$\Phi 16 \ 6 \times M2.5$	2.5mm
	2400	7.4V	380W	10A	0.4	0.1578	$\Phi 2.3 \times L 15\text{mm}$	$\Phi 20 \times 40\text{mm}$	60g	$\Phi 16 \ 6 \times M2.5$	2.5mm
	1950	7.4V	380W	8A	0.2	0.2297	$\Phi 2.3 \times L 15\text{mm}$	$\Phi 20 \times 40\text{mm}$	60g	$\Phi 16 \ 6 \times M2.5$	2.5mm

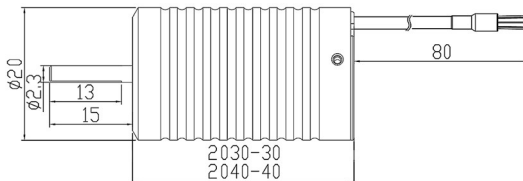
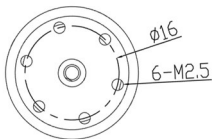

INRUNNER BRUSHLESS MOTOR

X-TEAM遥控车模系列内转子无刷电机

XTI-24系列四磁极无感无刷电机

适用于：1/16越野、大脚遥控车，300~550mm船模

Available for class 370-1/16th or 1/12th scale vehicles
 Number of stator slot: 12G 4P
 Sensored or sensorless: Sensorless
 Diameter of shaft: Φ 2mm- Φ 3.175mm
 Motor size: Diameter 28 / Length 30~45mm
 Stator diameter: Φ 22.5mm
 Available winding: Delta/Star (Δ/Y)

Technique:

- Hand-wound for maximum copper fill.
- Precision-balanced rotor will boost the efficiency and power performance of the motor.
- Nickel-plated sintered neodymium rotor for maximum motor acceleration, braking power and performance in high-temperature conditions.



型号	KV (rpm/v)	最大电压	最大功率	最大电流	空载电流	电阻 (Ω)	轴径x长度	马达尺寸	重量 (g)	安装孔尺寸 (mm)	螺丝孔深度
XTI-2430	9200	7.5V	200W	28A	3.8A	0.0026	Φ 2.3*L12mm	Φ 24*L30mm	50g	Φ 16 6*M2.5	4mm
	8200	7.2V	200W	26A	3.6A	0.0038	Φ 2.3*L12mm	Φ 24*L30mm	50g	Φ 16 6*M2.5	4mm
	6300	8.4V	200W	24A	2.5A	0.0058	Φ 2.3*L12mm	Φ 24*L30mm	50g	Φ 16 6*M2.5	4mm
	5800	10.8V	200W	18A	2.3A	0.0068	Φ 2.3*L12mm	Φ 24*L30mm	50g	Φ 16 6*M2.5	4mm
	5300	13V	200W	14A	1.9A	0.0127	Φ 2.3*L12mm	Φ 24*L30mm	50g	Φ 16 6*M2.5	4mm
XTI-2435	6100	9.6V	300W	32A	2.5A	0.0032	Φ 2.3*L12mm	Φ 24*L35mm	58g	Φ 16 6*M2.5	4mm
	5000	10.2V	300W	24A	2.2A	0.0057	Φ 2.3*L12mm	Φ 24*L35mm	58g	Φ 16 6*M2.5	4mm
	4900	11.6V	300W	22A	2.0A	0.0066	Φ 2.3*L12mm	Φ 24*L35mm	58g	Φ 16 6*M2.5	4mm
	4800	12.6V	300W	20A	1.7A	0.0095	Φ 2.3*L12mm	Φ 24*L35mm	58g	Φ 16 6*M2.5	4mm
	4500	13.2V	300W	18A	1.4A	0.0122	Φ 2.3*L12mm	Φ 24*L35mm	58g	Φ 16 6*M2.5	4mm
	3300	15.8V	300W	16A	1.2A	0.0167	Φ 2.3*L12mm	Φ 24*L35mm	58g	Φ 16 6*M2.5	4mm
XTI-2440	6250	9V	400W	42A	3.2A	0.0040	Φ 2.3*L12mm	Φ 24*L40mm	63g	Φ 16 6*M2.5	4mm
	6080	8.4V	400W	47A	2.9A	0.0032	Φ 2.3*L12mm	Φ 24*L40mm	63g	Φ 16 6*M2.5	4mm
	4600	10.8V	400W	37A	2.6A	0.0057	Φ 2.3*L12mm	Φ 24*L40mm	63g	Φ 16 6*M2.5	4mm
	4000	12.6V	400W	32A	2.2A	0.0117	Φ 2.3*L12mm	Φ 24*L40mm	63g	Φ 16 6*M2.5	4mm
XTI-2445	5400	8.4V	500W	49A	3.0A	0.0042	Φ 2.3*L12mm	Φ 24*L45mm	76g	Φ 16 6*M2.5	4mm
	4700	10V	500W	35A	2.0A	0.0035	Φ 2.3*L12mm	Φ 24*L45mm	76g	Φ 16 6*M2.5	4mm
	3600	14.8V	500W	32A	1.8A	0.0066	Φ 2.3*L12mm	Φ 24*L45mm	76g	Φ 16 6*M2.5	4mm
	3000	14V	500W	24A	1.5A	0.0117	Φ 2.3*L12mm	Φ 24*L45mm	76g	Φ 16 6*M2.5	4mm

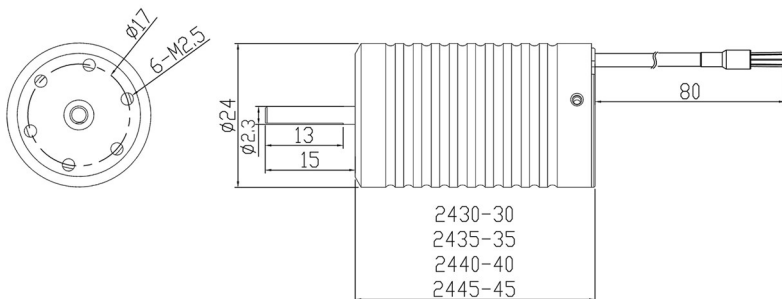

INRUNNER BRUSHLESS MOTOR

X-TEAM遥控车模系列内转子无刷电机

XTI-2845四磁极无感无刷电机

适用于：1/14平跑、越野遥控车，300~400mm遥控船

Available for class 380-1/12th or 1/10th scale vehicles
 Number of stator slot: 12G 4P
 Sensored or sensorless: Sensorless
 Diameter of shaft: $\Phi 3.175\text{mm}-\Phi 5\text{mm}$
 Motor size: Diameter 28 / Length 45mm
 Stator diameter: $\Phi 26.5\text{mm}$
 Available winding: Delta/Star (Δ/Y)

Technique:

- Hand-wound for maximum copper fill.
- Precision-balanced rotor will boost the efficiency and power performance of the motor.
- Nickel-plated sintered neodymium rotor for maximum motor acceleration, braking power and performance in high-temperature conditions.



型号	KV (rpm/v)	最大 电压	最大 功率	最大 电流	轴径x长度	马达尺寸	重量 (g)	安装孔尺寸 (mm)	螺丝孔 深度
XTI-2845	8150	7V	800W	105A	$\Phi 5 \times L 15\text{mm}$	$\Phi 28 \times 45\text{mm}$	244g	$\Phi 25 \ 4 \times M3$	6mm
	6550	9V	800W	80A	$\Phi 5 \times L 15\text{mm}$	$\Phi 36 \times 60\text{mm}$	244g	$\Phi 25 \ 4 \times M3$	6mm
	5450	10V	800W	75A	$\Phi 5 \times L 15\text{mm}$	$\Phi 36 \times 60\text{mm}$	244g	$\Phi 25 \ 4 \times M3$	6mm
	4700	12V	800W	60A	$\Phi 5 \times L 15\text{mm}$	$\Phi 36 \times 60\text{mm}$	244g	$\Phi 25 \ 4 \times M3$	6mm
	4400	13V	800W	58A	$\Phi 5 \times L 15\text{mm}$	$\Phi 36 \times 60\text{mm}$	244g	$\Phi 25 \ 4 \times M3$	6mm
	4100	14V	800W	57A	$\Phi 5 \times L 15\text{mm}$	$\Phi 36 \times 60\text{mm}$	244g	$\Phi 25 \ 4 \times M3$	6mm
	3650	16V	800W	50A	$\Phi 5 \times L 15\text{mm}$	$\Phi 36 \times 60\text{mm}$	244g	$\Phi 25 \ 4 \times M3$	6mm
	3300	18V	800W	45A	$\Phi 5 \times L 15\text{mm}$	$\Phi 36 \times 60\text{mm}$	244g	$\Phi 25 \ 4 \times M3$	6mm
	3000	20V	800W	38A	$\Phi 5 \times L 15\text{mm}$	$\Phi 36 \times 60\text{mm}$	244g	$\Phi 25 \ 4 \times M3$	6mm
	2900	21V	800W	35A	$\Phi 5 \times L 15\text{mm}$	$\Phi 36 \times 60\text{mm}$	244g	$\Phi 25 \ 4 \times M3$	6mm
	2750	21V	800W	35A	$\Phi 5 \times L 15\text{mm}$	$\Phi 36 \times 60\text{mm}$	244g	$\Phi 25 \ 4 \times M3$	6mm
	2550	23V	800W	32A	$\Phi 5 \times L 15\text{mm}$	$\Phi 36 \times 60\text{mm}$	244g	$\Phi 25 \ 4 \times M3$	6mm
	2000	30V	800W	25A	$\Phi 5 \times L 15\text{mm}$	$\Phi 36 \times 60\text{mm}$	244g	$\Phi 25 \ 4 \times M3$	6mm
1800	33V	800W	24A	$\Phi 5 \times L 15\text{mm}$	$\Phi 36 \times 60\text{mm}$	244g	$\Phi 25 \ 4 \times M3$	6mm	

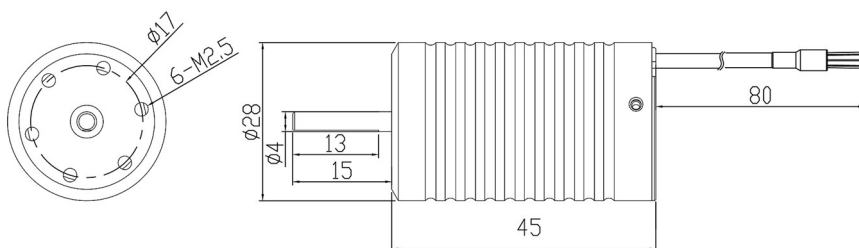

INRUNNER BRUSHLESS MOTOR

X-TEAM遥控车模系列内转子无刷电机

XTI-2850四磁极无感无刷电机

适用于：1/12越野遥控车，300~450mm遥控船，65mm涵道

Available for class 380-1/10th scale vehicles
 Number of stator slot: 12G 4P
 Sensored or sensorless: Sensorless
 Diameter of shaft: $\Phi 3.175\text{mm}-\Phi 5\text{mm}$
 Motor size: Diameter 28 / Length 50mm
 Stator diameter: $\Phi 26.5\text{mm}$
 Available winding: Delta/Star (Δ/Y)

Technique:

- Hand-wound for maximum copper fill.
- Precision-balanced rotor will boost the efficiency and power performance of the motor.
- Nickel-plated sintered neodymium rotor for maximum motor acceleration, braking power and performance in high-temperature conditions.



型号	KV (rpm/v)	最大电压	最大功率	最大电流	轴径x长度	马达尺寸	重量 (g)	安装孔尺寸 (mm)	螺丝孔深度
XTI-2850	6550	9V	1000W	108A	$\Phi 4 \times L 15\text{mm}$	$\Phi 28 \times 50\text{mm}$	120g	$\Phi 16 \ 4 \times M3$	5mm
	5300	11V	1000W	82A	$\Phi 4 \times L 15\text{mm}$	$\Phi 28 \times 50\text{mm}$	120g	$\Phi 16 \ 4 \times M3$	5mm
	4450	13V	1000W	75A	$\Phi 4 \times L 15\text{mm}$	$\Phi 28 \times 50\text{mm}$	120g	$\Phi 16 \ 4 \times M3$	5mm
	3800	15V	1000W	62A	$\Phi 4 \times L 15\text{mm}$	$\Phi 28 \times 50\text{mm}$	120g	$\Phi 16 \ 4 \times M3$	5mm
	3600	16V	1000W	60A	$\Phi 4 \times L 15\text{mm}$	$\Phi 28 \times 50\text{mm}$	120g	$\Phi 16 \ 4 \times M3$	5mm
	3350	18V	1000W	53A	$\Phi 4 \times L 15\text{mm}$	$\Phi 28 \times 50\text{mm}$	120g	$\Phi 16 \ 4 \times M3$	5mm
	2900	20V	1000W	42A	$\Phi 4 \times L 15\text{mm}$	$\Phi 28 \times 50\text{mm}$	120g	$\Phi 16 \ 4 \times M3$	5mm
	2700	22V	1000W	45A	$\Phi 4 \times L 15\text{mm}$	$\Phi 28 \times 50\text{mm}$	120g	$\Phi 16 \ 4 \times M3$	5mm
	2450	24V	1000W	40A	$\Phi 4 \times L 15\text{mm}$	$\Phi 28 \times 50\text{mm}$	120g	$\Phi 16 \ 4 \times M3$	5mm
	2250	26V	1000W	38A	$\Phi 4 \times L 15\text{mm}$	$\Phi 28 \times 50\text{mm}$	120g	$\Phi 16 \ 4 \times M3$	5mm
	2000	40V	1000W	25A	$\Phi 4 \times L 15\text{mm}$	$\Phi 28 \times 50\text{mm}$	120g	$\Phi 16 \ 4 \times M3$	5mm
	1800	33V	1000W	30A	$\Phi 4 \times L 15\text{mm}$	$\Phi 28 \times 50\text{mm}$	120g	$\Phi 16 \ 4 \times M3$	5mm
	1600	37V	1000W	25A	$\Phi 4 \times L 15\text{mm}$	$\Phi 28 \times 50\text{mm}$	120g	$\Phi 16 \ 4 \times M3$	5mm
	1450	40V	1000W	24A	$\Phi 4 \times L 15\text{mm}$	$\Phi 28 \times 50\text{mm}$	120g	$\Phi 16 \ 4 \times M3$	5mm

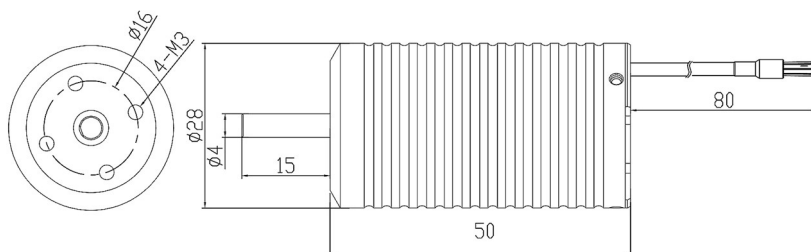

INRUNNER BRUSHLESS MOTOR

X-TEAM遥控车模系列内转子无刷电机

XTI-2860四磁极无感无刷电机

适用于：1/12越野、大脚车模，400~550mm船模，68mm涵道

Available for class 380-1/12th scale vehicles
 Number of stator slot: 12G 4P
 Sensored or sensorless: Sensorless
 Diameter of shaft: $\Phi 3.175\text{mm}-\Phi 5\text{mm}$
 Motor size: Diameter 28 / Length 60mm
 Stator diameter: $\Phi 26.5\text{mm}$
 Available winding: Delta/Star (Δ/Y)

Technique:

- Hand-wound for maximum copper fill.
- Precision-balanced rotor will boost the efficiency and power performance of the motor.
- Nickel-plated sintered neodymium rotor for maximum motor acceleration, braking power and performance in high-temperature conditions.



型号	KV (rpm/v)	最大电压	最大功率	最大电流	轴径x长度	马达尺寸	重量 (g)	安装孔尺寸 (mm)	螺丝孔深度
XTI-2860	5050	11V	1300W	120A	$\Phi 4 \times L1.5\text{mm}$	$\Phi 28^*60\text{mm}$	154g	$\Phi 16 \ 4 \times M3$	5mm
	4050	14V	1300W	85A	$\Phi 4 \times L1.5\text{mm}$	$\Phi 28^*60\text{mm}$	154g	$\Phi 16 \ 4 \times M3$	5mm
	3400	17V	1300W	80A	$\Phi 4 \times L1.5\text{mm}$	$\Phi 28^*60\text{mm}$	154g	$\Phi 16 \ 4 \times M3$	5mm
	2900	20V	1300W	65A	$\Phi 4 \times L1.5\text{mm}$	$\Phi 28^*60\text{mm}$	154g	$\Phi 16 \ 4 \times M3$	5mm
	2750	21V	1300W	60A	$\Phi 4 \times L1.5\text{mm}$	$\Phi 28^*60\text{mm}$	154g	$\Phi 16 \ 4 \times M3$	5mm
	2550	23V	1300W	58A	$\Phi 4 \times L1.5\text{mm}$	$\Phi 28^*60\text{mm}$	154g	$\Phi 16 \ 4 \times M3$	5mm
	2200	27V	1300W	45A	$\Phi 4 \times L1.5\text{mm}$	$\Phi 28^*60\text{mm}$	154g	$\Phi 16 \ 4 \times M3$	5mm
	2100	35V	1300W	38A	$\Phi 4 \times L1.5\text{mm}$	$\Phi 28^*60\text{mm}$	154g	$\Phi 16 \ 4 \times M3$	5mm
	1850	32V	1300W	40A	$\Phi 4 \times L1.5\text{mm}$	$\Phi 28^*60\text{mm}$	154g	$\Phi 16 \ 4 \times M3$	5mm
	1700	35V	1300W	38A	$\Phi 4 \times L1.5\text{mm}$	$\Phi 28^*60\text{mm}$	154g	$\Phi 16 \ 4 \times M3$	5mm
	1600	37V	1300W	34A	$\Phi 4 \times L1.5\text{mm}$	$\Phi 28^*60\text{mm}$	154g	$\Phi 16 \ 4 \times M3$	5mm
	1400	43V	1300W	30A	$\Phi 4 \times L1.5\text{mm}$	$\Phi 28^*60\text{mm}$	154g	$\Phi 16 \ 4 \times M3$	5mm
1250	48V	1300W	26A	$\Phi 4 \times L1.5\text{mm}$	$\Phi 28^*60\text{mm}$	154g	$\Phi 16 \ 4 \times M3$	5mm	
1100	54V	1300W	24A	$\Phi 4 \times L1.5\text{mm}$	$\Phi 28^*60\text{mm}$	154g	$\Phi 16 \ 4 \times M3$	5mm	

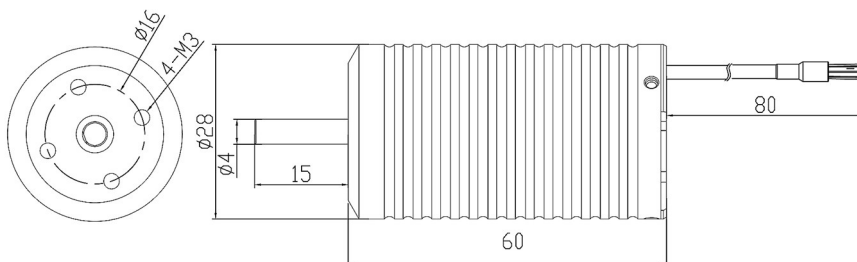

INRUNNER BRUSHLESS MOTOR

X-TEAM遥控车模系列内转子无刷电机

XTI-3650四磁极无感无刷电机

适用于：1/10平跑、越野、大脚遥控车，400~600mm船模

Available for class 540-1/10th scale vehicles
 Number of stator slot: 12G 4P
 Sensored or sensorless: Sensorless
 Diameter of shaft: $\Phi 3.17\text{mm}$ - $\Phi 5\text{mm}$
 Motor size: Diameter 36 / Length 50mm
 Stator diameter: $\Phi 34.3\text{mm}$
 Available winding: Delta/Star (Δ /Y)

Technique:

- Hand-wound for maximum copper fill.
- Precision-balanced rotor will boost the efficiency and power performance of the motor.
- Nickel-plated sintered neodymium rotor for maximum motor acceleration, braking power and performance in high-temperature conditions.

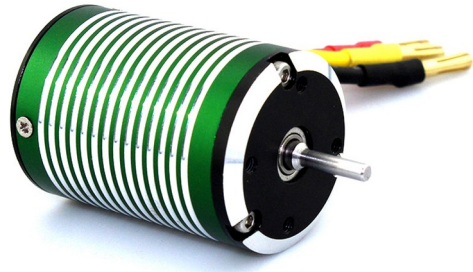

型号	KV (rpm/v)	最大电压	最大功率	最大电流	轴径x长度	马达尺寸	重量 (g)	安装孔尺寸 (mm)	螺丝孔深度
XTI-3650	5400	11V	1300W	115A	$\Phi 3.175 \times L15\text{mm}$	$\Phi 36^*50\text{mm}$	198g	$\Phi 25 \ 4 \times M3$	6mm
	4550	13V	1300W	100A	$\Phi 3.175 \times L15\text{mm}$	$\Phi 36^*50\text{mm}$	198g	$\Phi 25 \ 4 \times M3$	6mm
	4250	15V	1300W	85A	$\Phi 3.175 \times L15\text{mm}$	$\Phi 36^*50\text{mm}$	198g	$\Phi 25 \ 4 \times M3$	6mm
	3900	15V	1300W	86A	$\Phi 3.175 \times L15\text{mm}$	$\Phi 36^*50\text{mm}$	198g	$\Phi 25 \ 4 \times M3$	6mm
	3650	16V	1300W	81A	$\Phi 3.175 \times L15\text{mm}$	$\Phi 36^*50\text{mm}$	198g	$\Phi 25 \ 4 \times M3$	6mm
	3500	17V	1300W	76A	$\Phi 3.175 \times L15\text{mm}$	$\Phi 36^*50\text{mm}$	198g	$\Phi 25 \ 4 \times M3$	6mm
	3100	21V	1300W	61A	$\Phi 3.175 \times L15\text{mm}$	$\Phi 36^*50\text{mm}$	198g	$\Phi 25 \ 4 \times M3$	6mm
	2750	21V	1300W	61A	$\Phi 3.175 \times L15\text{mm}$	$\Phi 36^*50\text{mm}$	198g	$\Phi 25 \ 4 \times M3$	6mm
	2500	24V	1300W	54A	$\Phi 3.175 \times L15\text{mm}$	$\Phi 36^*50\text{mm}$	198g	$\Phi 25 \ 4 \times M3$	6mm
	2300	26V	1300W	50A	$\Phi 3.175 \times L15\text{mm}$	$\Phi 36^*50\text{mm}$	198g	$\Phi 25 \ 4 \times M3$	6mm
	2100	28V	1300W	46A	$\Phi 3.175 \times L15\text{mm}$	$\Phi 36^*50\text{mm}$	198g	$\Phi 25 \ 4 \times M3$	6mm
	1850	32V	1300W	40A	$\Phi 3.175 \times L15\text{mm}$	$\Phi 36^*50\text{mm}$	198g	$\Phi 25 \ 4 \times M3$	6mm
	1650	36V	1300W	36A	$\Phi 3.175 \times L15\text{mm}$	$\Phi 36^*50\text{mm}$	198g	$\Phi 25 \ 4 \times M3$	6mm
	1350	44V	1300W	28A	$\Phi 3.175 \times L15\text{mm}$	$\Phi 36^*50\text{mm}$	198g	$\Phi 25 \ 4 \times M3$	6mm

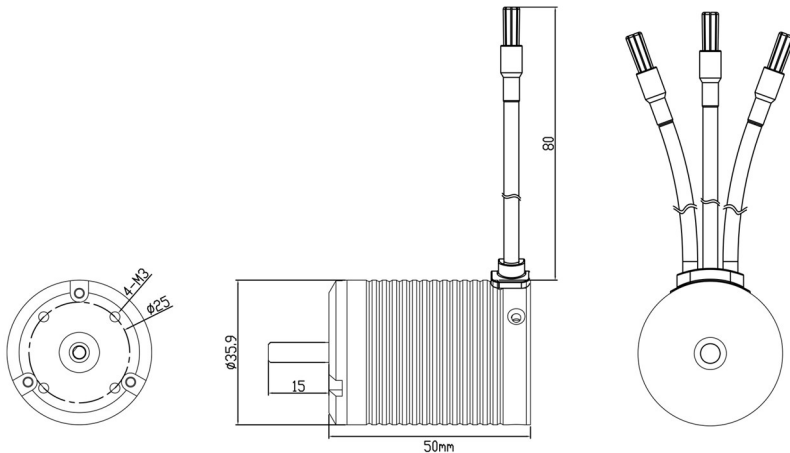

INRUNNER BRUSHLESS MOTOR

X-TEAM遥控车模系列内转子无刷电机

XTI-3660四磁极无感无刷电机

适用于：1/8越野、大脚遥控车，550~850mm船模，80mm涵道

Available for class 540-1/8th scale vehicles
 Number of stator slot: 12G 4P
 Sensored or sensorless: Sensorless
 Diameter of shaft: $\Phi 3.17\text{mm}-\Phi 5\text{mm}$
 Motor size: Diameter $\Phi 36$ / Length 60mm
 Stator diameter: $\Phi 34.3\text{mm}$
 Available winding: Delta/Star (Δ / Y)

Technique:

- Hand-wound for maximum copper fill.
- Precision-balanced rotor will boost the efficiency and power performance of the motor.
- Nickel-plated sintered neodymium rotor for maximum motor acceleration, braking power and performance in high-temperature conditions.

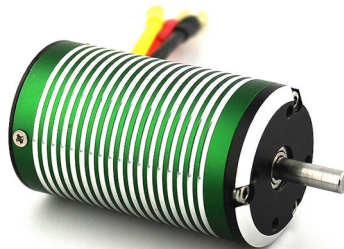

型号	KV (rpm/V)	最大电压	最大功率	最大电流	轴径x长度	马达尺寸	重量 (g)	安装孔尺寸 (mm)	螺丝孔深度
XTI-3660	4650	12V	1700W	130A	$\Phi 5 \times L15\text{mm}$	$\Phi 36 \times 60\text{mm}$	244g	$\Phi 25 \ 4 \times M3$	6mm
	3800	15V	1700W	112A	$\Phi 5 \times L15\text{mm}$	$\Phi 36 \times 60\text{mm}$	244g	$\Phi 25 \ 4 \times M3$	6mm
	3500	18V	1700W	93A	$\Phi 5 \times L15\text{mm}$	$\Phi 36 \times 60\text{mm}$	244g	$\Phi 25 \ 4 \times M3$	6mm
	3200	18V	1700W	94A	$\Phi 5 \times L15\text{mm}$	$\Phi 36 \times 60\text{mm}$	244g	$\Phi 25 \ 4 \times M3$	6mm
	2700	22V	1700W	78A	$\Phi 5 \times L15\text{mm}$	$\Phi 36 \times 60\text{mm}$	244g	$\Phi 25 \ 4 \times M3$	6mm
	2550	23V	1700W	74A	$\Phi 5 \times L15\text{mm}$	$\Phi 36 \times 60\text{mm}$	244g	$\Phi 25 \ 4 \times M3$	6mm
	2400	25V	1700W	70A	$\Phi 5 \times L15\text{mm}$	$\Phi 36 \times 60\text{mm}$	244g	$\Phi 25 \ 4 \times M3$	6mm
	2150	28V	1700W	61A	$\Phi 5 \times L15\text{mm}$	$\Phi 36 \times 60\text{mm}$	244g	$\Phi 25 \ 4 \times M3$	6mm
	1900	31V	1700W	55A	$\Phi 5 \times L15\text{mm}$	$\Phi 36 \times 60\text{mm}$	244g	$\Phi 25 \ 4 \times M3$	6mm
	1750	34V	1700W	50A	$\Phi 5 \times L15\text{mm}$	$\Phi 36 \times 60\text{mm}$	244g	$\Phi 25 \ 4 \times M3$	6mm
	1500	40V	1700W	43A	$\Phi 5 \times L15\text{mm}$	$\Phi 36 \times 60\text{mm}$	244g	$\Phi 25 \ 4 \times M3$	6mm
	1300	46V	1700W	38A	$\Phi 5 \times L15\text{mm}$	$\Phi 36 \times 60\text{mm}$	244g	$\Phi 25 \ 4 \times M3$	6mm
1150	52V	1700W	33A	$\Phi 5 \times L15\text{mm}$	$\Phi 36 \times 60\text{mm}$	244g	$\Phi 25 \ 4 \times M3$	6mm	
1050	57V	1700W	30A	$\Phi 5 \times L15\text{mm}$	$\Phi 36 \times 60\text{mm}$	244g	$\Phi 25 \ 4 \times M3$	6mm	

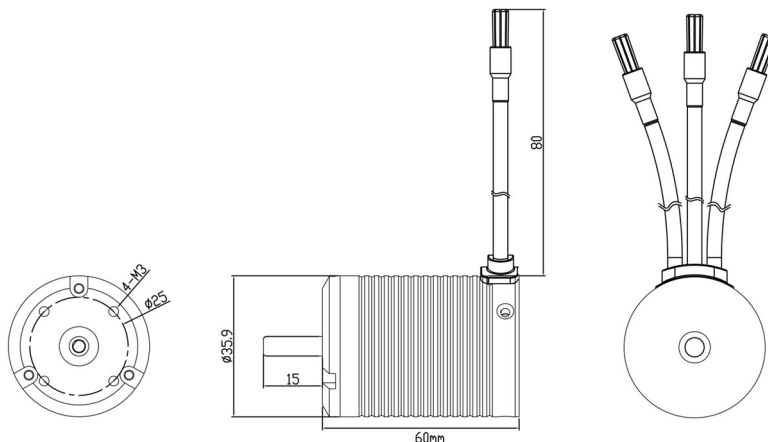

INRUNNER BRUSHLESS MOTOR

X-TEAM遥控车模系列内转子无刷电机

XTI-3665四磁极无感无刷电机

适用于：1/8越野、大脚遥控车，650~1000mm船模，90mm涵道

Available for class 540-1/8th scale vehicles
 Number of stator slot: 12G 4P
 Sensored or sensorless: Sensorless
 Diameter of shaft: $\Phi 3.17\text{mm}-\Phi 5\text{mm}$
 Motor size: Diameter $\Phi 36$ / Length 65mm
 Stator diameter: $\Phi 34.3\text{mm}$
 Available winding: Delta/Star (Δ/Y)

Technique:

- Hand-wound for maximum copper fill.
- Precision-balanced rotor will boost the efficiency and power performance of the motor.
- Nickel-plated sintered neodymium rotor for maximum motor acceleration, braking power and performance in high-temperature conditions.

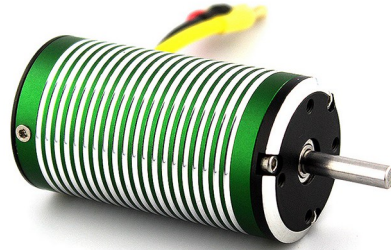

型号	KV (rpm/v)	最大电压	最大功率	最大电流	轴径x长度	马达尺寸	重量 (g)	安装孔尺寸 (mm)	螺丝孔深度
XTI-3665	2700	22V	2000W	135A	$\Phi 5 \times L1.5\text{mm}$	$\Phi 36^*65\text{mm}$	276g	$\Phi 25 \ 4 \times M3$	6mm
	2500	26V	2000W	110A	$\Phi 5 \times L1.5\text{mm}$	$\Phi 36^*65\text{mm}$	276g	$\Phi 25 \ 4 \times M3$	6mm
	2300	26V	2000W	90A	$\Phi 5 \times L1.5\text{mm}$	$\Phi 36^*65\text{mm}$	276g	$\Phi 25 \ 4 \times M3$	6mm
	2100	28V	2000W	76A	$\Phi 5 \times L1.5\text{mm}$	$\Phi 36^*65\text{mm}$	276g	$\Phi 25 \ 4 \times M3$	6mm
	2050	28V	2000W	72A	$\Phi 5 \times L1.5\text{mm}$	$\Phi 36^*65\text{mm}$	276g	$\Phi 25 \ 4 \times M3$	6mm
	1900	37V	2000W	72A	$\Phi 5 \times L1.5\text{mm}$	$\Phi 36^*65\text{mm}$	276g	$\Phi 25 \ 4 \times M3$	6mm
	1800	33V	2000W	60A	$\Phi 5 \times L1.5\text{mm}$	$\Phi 36^*65\text{mm}$	276g	$\Phi 25 \ 4 \times M3$	6mm
	1700	35V	2000W	58A	$\Phi 5 \times L1.5\text{mm}$	$\Phi 36^*65\text{mm}$	276g	$\Phi 25 \ 4 \times M3$	6mm
	1600	37V	2000W	55A	$\Phi 5 \times L1.5\text{mm}$	$\Phi 36^*65\text{mm}$	276g	$\Phi 25 \ 4 \times M3$	6mm
	1450	40V	2000W	53A	$\Phi 5 \times L1.5\text{mm}$	$\Phi 36^*65\text{mm}$	276g	$\Phi 25 \ 4 \times M3$	6mm
	1200	48V	2000W	42A	$\Phi 5 \times L1.5\text{mm}$	$\Phi 36^*65\text{mm}$	276g	$\Phi 25 \ 4 \times M3$	6mm
	1050	54V	2000W	38A	$\Phi 5 \times L1.5\text{mm}$	$\Phi 36^*65\text{mm}$	276g	$\Phi 25 \ 4 \times M3$	6mm
	950	60V	2000W	34A	$\Phi 5 \times L1.5\text{mm}$	$\Phi 36^*65\text{mm}$	276g	$\Phi 25 \ 4 \times M3$	6mm
	850	70V	2000W	30A	$\Phi 5 \times L1.5\text{mm}$	$\Phi 36^*65\text{mm}$	276g	$\Phi 25 \ 4 \times M3$	6mm

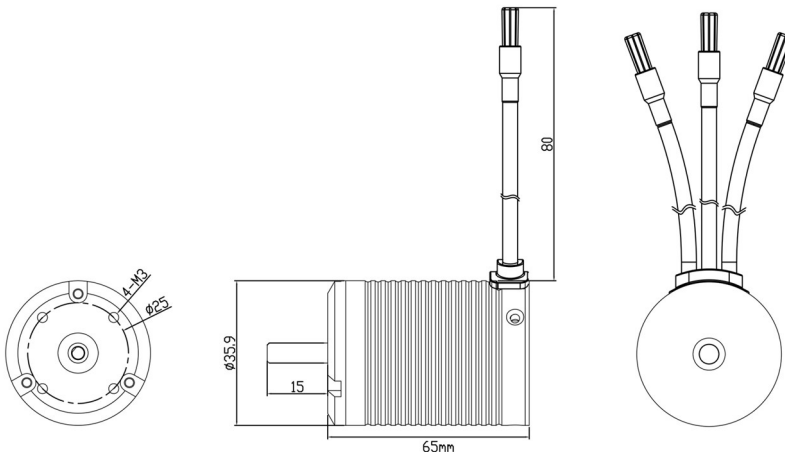

INRUNNER BRUSHLESS MOTOR

X-TEAM遥控车模系列内转子无刷电机

XTI-36系列四磁极无感无刷电机

适用于：1/8大脚、越野遥控车，650~1500mm船模，90mm涵道

Available for class 550-1/8th scale vehicles
 Number of stator slot: 12G 4P
 Sensored or sensorless: Sensorless
 Diameter of shaft: $\Phi 3.17\text{mm}-\Phi 5\text{mm}$
 Motor size: Diameter $\Phi 36$ / Length 74mm
 Stator diameter: $\Phi 34.3\text{mm}$
 Available winding: Delta/Star (Δ/Y)

Technique:

- Hand-wound for maximum copper fill.
- Precision-balanced rotor will boost the efficiency and power performance of the motor.
- Nickel-plated sintered neodymium rotor for maximum motor acceleration, braking power and performance in high-temperature conditions.

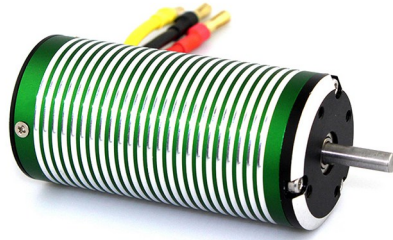

型号	KV (rpm/v)	最大 电压	最大 功率	最大 电流	轴径x长度	马达尺寸	重量 (g)	安装孔尺寸 (mm)	螺丝孔 深度
XTI-3670	3100	16V	2200W	102A	$\Phi 5 \times L15\text{mm}$	$\Phi 36^*70\text{mm}$	296g	$\Phi 25$ 4xM3	6mm
	2850	17V	2200W	95A	$\Phi 5 \times L15\text{mm}$	$\Phi 36^*70\text{mm}$	296g	$\Phi 25$ 4xM3	6mm
	2650	19V	2200W	86A	$\Phi 5 \times L15\text{mm}$	$\Phi 36^*70\text{mm}$	296g	$\Phi 25$ 4xM3	6mm
	2050	23V	2200W	70A	$\Phi 5 \times L15\text{mm}$	$\Phi 36^*70\text{mm}$	296g	$\Phi 25$ 4xM3	6mm
	1700	26V	2200W	60A	$\Phi 5 \times L15\text{mm}$	$\Phi 36^*70\text{mm}$	296g	$\Phi 25$ 4xM3	6mm
	1350	37V	2200W	43A	$\Phi 5 \times L15\text{mm}$	$\Phi 36^*70\text{mm}$	296g	$\Phi 25$ 4xM3	6mm
XTI-3674	1100	42V	2200W	38A	$\Phi 5 \times L15\text{mm}$	$\Phi 36^*70\text{mm}$	296g	$\Phi 25$ 4xM3	6mm
	3300	18V	2400W	133A	$\Phi 5 \times L15\text{mm}$	$\Phi 36^*74\text{mm}$	306g	$\Phi 25$ 4xM3	6mm
	2650	23V	2400W	104A	$\Phi 5 \times L15\text{mm}$	$\Phi 36^*74\text{mm}$	306g	$\Phi 25$ 4xM3	6mm
	2200	27V	2400W	89A	$\Phi 5 \times L15\text{mm}$	$\Phi 36^*74\text{mm}$	306g	$\Phi 25$ 4xM3	6mm
	1900	32V	2400W	75A	$\Phi 5 \times L15\text{mm}$	$\Phi 36^*74\text{mm}$	306g	$\Phi 25$ 4xM3	6mm
	1700	35V	2400W	69A	$\Phi 5 \times L15\text{mm}$	$\Phi 36^*74\text{mm}$	306g	$\Phi 25$ 4xM3	6mm
	1300	46V	2400W	52A	$\Phi 5 \times L15\text{mm}$	$\Phi 36^*74\text{mm}$	306g	$\Phi 25$ 4xM3	6mm
	1100	55V	2400W	44A	$\Phi 5 \times L15\text{mm}$	$\Phi 36^*74\text{mm}$	306g	$\Phi 25$ 4xM3	6mm
850	71V	2400W	34A	$\Phi 5 \times L15\text{mm}$	$\Phi 36^*74\text{mm}$	306g	$\Phi 25$ 4xM3	6mm	

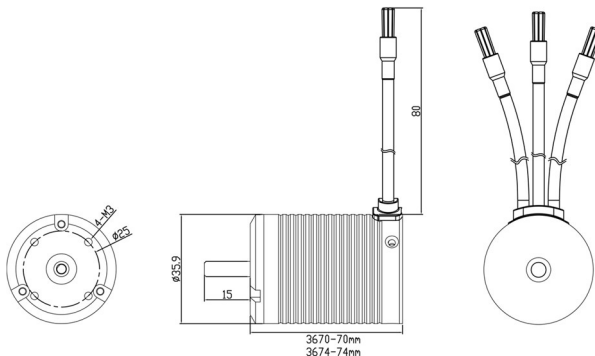

INRUNNER BRUSHLESS MOTOR

X-TEAM遥控车模系列内转子无刷电机

XTI-36系列2磁极有感无刷电机

适用于：1/10电房、漂移、平跑、攀爬遥控车



Available for class 540-1/10th scale vehicles
 Number of stator slot: 3G 2P
 Sensored or sensorless: Sensored
 Diameter of shaft: Φ3.17mm-Φ5mm
 Motor size: Diameter ≥ Φ36 / Length 52mm
 Stator diameter: Φ34.3mm
 Available winding: Star (Y)



Technique:

- Hand-wound for maximum copper fill.
- Precision-balanced rotor will boost the efficiency and power performance of the motor.
- Nickel-plated sintered neodymium rotor for maximum motor acceleration, braking power and performance in high-temperature conditions.

型号	T数	KV (rpm/v)	最大电压	最大电流	空载电流	电阻 (Ω)	转子极数	功率	轴径x长度	转子尺寸	重量 (g)	竞赛级别
XTI-540Y	3.5T	9100	1S	130A	9.1A	0.0026	2P	600W	Φ3.175xL12.7mm	Φ12.5*Φ5mm	176	MODIFIED
	4.5T	7620	1~2S	108A	6.9A	0.0042	2P	490W	Φ3.175xL12.7mm	Φ12.5*Φ5mm	176	MODIFIED
	5.5T	6450	1~2S	100A	5.8A	0.0061	2P	430W	Φ3.175xL12.7mm	Φ12.5*Φ5mm	176	MODIFIED
	6.5T	5350	1~2S	94A	4.1A	0.0087	2P	390W	Φ3.175xL12.7mm	Φ12.5*Φ5mm	176	MODIFIED
	7.5T	4700	1~2S	86A	3.5A	0.0104	2P	360W	Φ3.175xL12.7mm	Φ12.5*Φ5mm	176	MODIFIED
	8.5T	4100	1~3S	80A	3.2A	0.0138	2P	340W	Φ3.175xL12.7mm	Φ12.5*Φ5mm	176	MODIFIED
	9.5T	3700	1~3S	70A	2.7A	0.0165	2P	290W	Φ3.175xL12.7mm	Φ12.5*Φ5mm	176	MODIFIED
	10.5T	3450	1~3S	63A	1.9A	0.0208	2P	250W	Φ3.175xL12.7mm	Φ12.5*Φ5mm	176	MODIFIED
	11.5T	3200	1~3S	56A	1.8A	0.0256	2P	220W	Φ3.175xL12.7mm	Φ12.5*Φ5mm	176	MODIFIED
	13.5T	2860	1~3S	49A	1.6A	0.0331	2P	190W	Φ3.175xL12.7mm	Φ12.5*Φ5mm	176	MODIFIED
	10.5T	3600	1~3S	63A	1.6A	0.0208	2P	250W	Φ3.175xL12.7mm	Φ12.5*Φ7.2mm	178	SPEC
	13.5T	3050	1~3S	49A	1.3A	0.0331	2P	190W	Φ3.175xL12.7mm	Φ12.5*Φ7.2mm	178	SPEC
	17.5T	2200	1~3S	34A	1.0A	0.0514	2P	130W	Φ3.175xL12.7mm	Φ12.5*Φ7.2mm	178	SPEC
21.5T	1760	1~3S	28A	0.8A	0.0875	2P	100W	Φ3.175xL12.7mm	Φ12.5*Φ7.2mm	178	SPEC	

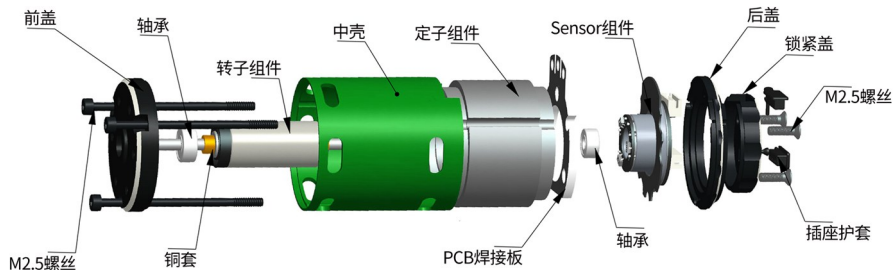

型号	T数	KV (rpm/v)	最大电压	最大电流	空载电流	电阻 (Ω)	转子极数	功率	轴径x长度	转子尺寸	重量 (g)
XTI-550Y	4.5T	4800	2S	107A	4.5A	0.0065	2P	900W	Φ5.0xL16.5mm	Φ12.5*Φ7.2mm	235
	5.5T	4000	2S	97A	3.4A	0.0085	2P	815W	Φ5.0xL16.5mm	Φ12.5*Φ7.2mm	235
	6.5T	3400	2~3S	59A	2.7A	0.0121	2P	745W	Φ5.0xL16.5mm	Φ12.5*Φ7.2mm	235
	7.5T	3000	2~3S	53A	1.6A	0.01365	2P	665W	Φ5.0xL16.5mm	Φ12.5*Φ7.2mm	235

INRUNNER BRUSHLESS MOTOR

X-TEAM遥控车模系列内转子无刷电机

XTI-40系列四磁极无感无刷电机

适用于：1/8平跑、越野、大脚，900~1500mm船模

Available for class 750-1/8th or 1/5th scale vehicles
 Number of stator slot: 12G 4P
 Sensored or sensorless: Sensorless
 Diameter of shaft: Φ 4mm- Φ 8mm
 Motor size: Diameter Φ 40 / Length 68-92mm
 Stator diameter: Φ 38mm
 Available winding: Delta/Star (Δ /Y)

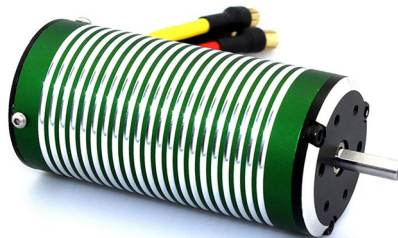

Technique:

- Hand-wound for maximum copper fill.
- Precision-balanced rotor will boost the efficiency and power performance of the motor.
- Nickel-plated sintered neodymium rotor for maximum motor acceleration, braking power and performance in high-temperature conditions.

型号	KV (rpm/v)	最大电压	最大功率	最大电流	轴径x长度	马达尺寸	重量 (g)	安装孔尺寸 (mm)	螺丝孔深度
XTI-4068	2700	18V	2000W	110A	Φ 5xL18mm	Φ 40*L68mm	311g	Φ 25 4xM2.5 Φ 25 2xM3.5	7mm
	2450	19V	2000W	105A	Φ 5xL18mm	Φ 40*L68mm	311g	Φ 25 4xM2.5 Φ 25 2xM3.5	7mm
	2100	23V	2000W	80A	Φ 5xL18mm	Φ 40*L68mm	311g	Φ 25 4xM2.5 Φ 25 2xM3.5	7mm
	1800	27V	2000W	70A	Φ 5xL18mm	Φ 40*L68mm	311g	Φ 25 4xM2.5 Φ 25 2xM3.5	7mm
	1400	35V	2000W	60A	Φ 5xL18mm	Φ 40*L68mm	311g	Φ 25 4xM2.5 Φ 25 2xM3.5	7mm
XTI-4074	2650	20V	2600W	130A	Φ 5xL20mm	Φ 40*L74mm	374g	Φ 25 4xM2.5 Φ 25 2xM3.5	7mm
	2150	23V	2600W	120A	Φ 5xL20mm	Φ 40*L74mm	374g	Φ 25 4xM2.5 Φ 25 2xM3.5	7mm
	2000	25V	2600W	116A	Φ 5xL20mm	Φ 40*L74mm	374g	Φ 25 4xM2.5 Φ 25 2xM3.5	7mm
	1400	35V	2600W	80A	Φ 5xL20mm	Φ 40*L74mm	374g	Φ 25 4xM2.5 Φ 25 2xM3.5	7mm
	1050	45V	2600W	65A	Φ 5xL20mm	Φ 40*L74mm	374g	Φ 25 4xM2.5 Φ 25 2xM3.5	7mm
XTI-4082	2200	20V	3500W	140A	Φ 5xL20mm	Φ 40*L82mm	485g	Φ 25 4xM2.5 Φ 25 2xM3.5	7mm
	1600	33V	3500W	120A	Φ 5xL20mm	Φ 40*L82mm	485g	Φ 25 4xM2.5 Φ 25 2xM3.5	7mm
	1450	33V	3500W	110A	Φ 5xL20mm	Φ 40*L82mm	485g	Φ 25 4xM2.5 Φ 25 2xM3.5	7mm
	1250	40V	3500W	82A	Φ 5xL20mm	Φ 40*L82mm	485g	Φ 25 4xM2.5 Φ 25 2xM3.5	7mm
	1000	45V	3500W	78A	Φ 5xL20mm	Φ 40*L82mm	485g	Φ 25 4xM2.5 Φ 25 2xM3.5	7mm
XTI-4092	1750	20V	4200W	140A	Φ 5xL20mm	Φ 40*L92mm	492g	Φ 25 4xM2.5 Φ 25 2xM3.5	7mm
	1500	23V	4200W	125A	Φ 5xL20mm	Φ 40*L92mm	492g	Φ 25 4xM2.5 Φ 25 2xM3.5	7mm
	1400	25V	4200W	118A	Φ 5xL20mm	Φ 40*L92mm	492g	Φ 25 4xM2.5 Φ 25 2xM3.5	7mm
	1300	26V	4200W	110A	Φ 5xL20mm	Φ 40*L92mm	492g	Φ 25 4xM2.5 Φ 25 2xM3.5	7mm
	1050	33V	4200W	102A	Φ 5xL20mm	Φ 40*L92mm	492g	Φ 25 4xM2.5 Φ 25 2xM3.5	7mm
	950	37V	4200W	80A	Φ 5xL20mm	Φ 40*L92mm	492g	Φ 25 4xM2.5 Φ 25 2xM3.5	7mm



INRUNNER BRUSHLESS MOTOR

X-TEAM遥控车模系列内转子无刷电机

XTI-42系列2磁极有感无刷电机

适用于：1/8平跑、越野、大脚、漂移、攀爬遥控车

Available for class 750-1/8th or 1/5th scale vehicles
Number of stator slot: 12G 4P
Sensored or sensorless: Sensored
Diameter of shaft: Φ4mm-Φ8mm
Motor size: Diameter ≥ Φ40 / Length 74mm
Stator diameter: Φ38mm(40Series) / Φ34.3mm(36 Series)
Available winding: Delta/Star (Δ/Y)

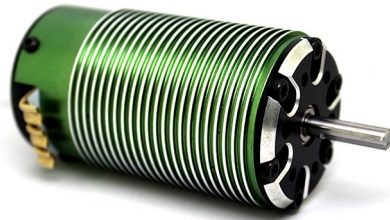

Technique:

- Hand-wound for maximum copper fill.
- Precision-balanced rotor will boost the efficiency and power performance of the motor.
- Nickel-plated sintered neodymium rotor for maximum motor acceleration, braking power and performance in high-temperature conditions.

型号	KV (rpm/v)	最大电压	最大功率	最大电流	轴径x长度	马达尺寸	重量 (g)	安装孔尺寸 (mm)	螺丝孔深度
XTI-4274Y	2150	23V	2600W	120A	Φ5xL20mm	Φ36*65mm	374g	Φ25 4xM3	7mm
	1800	25V	2600W	105A	Φ5xL20mm	Φ36*65mm	374g	Φ25 4xM3	7mm
	1650	27V	2600W	86A	Φ5xL20mm	Φ36*65mm	374g	Φ25 4xM3	7mm
XTI-3858Y	3550	13V	1700W	125A	Φ5xL16mm	Φ36*65mm	235g	Φ25 4xM3	5.5mm
	2900	17V	1700W	110A	Φ5xL16mm	Φ36*65mm	235g	Φ25 4xM3	5.5mm
	2200	25V	1700W	86A	Φ5xL16mm	Φ36*65mm	235g	Φ25 4xM3	5.5mm

XTI-42系列四磁极有感无刷电机

适用于：1/8平跑、电房、漂移、攀爬遥控车

Available for class 750-1/8th or 1/5th scale vehicles
Number of stator slot: 12G 4P
Sensored or sensorless: Sensored
Diameter of shaft: Φ4mm-Φ8mm
Motor size: Diameter ≥ Φ40 / Length 82mm
Stator diameter: Φ38mm(40Series) / Φ34.3mm(36 Series)
Available winding: Delta/Star (Δ/Y)



Technique:

- Hand-wound for maximum copper fill.
- Precision-balanced rotor will boost the efficiency and power performance of the motor.
- Nickel-plated sintered neodymium rotor for maximum motor acceleration, braking power and performance in high-temperature conditions.

型号	KV (rpm/v)	最大电压	最大功率	最大电流	轴径x长度	马达尺寸	重量 (g)	安装孔尺寸 (mm)	螺丝孔深度
XTI-4282Y	2200	23V	2600W	122A	Φ5xL19mm	Φ42*82mm	406g	Φ25 4xM3 Φ25 4xM4	7mm
	1800	25V	2600W	105A	Φ5xL19mm	Φ42*82mm	406g	Φ25 4xM3 Φ25 4xM4	7mm
	1600	28V	2600W	82A	Φ5xL19mm	Φ42*82mm	406g	Φ25 4xM3 Φ25 4xM4	7mm

INRUNNER BRUSHLESS MOTOR

X-TEAM遥控车模系列内转子无刷电机

XTI-57系列四磁极无感无刷电机

适用于：1/5攀爬、越野、大脚遥控车，900~1800mm船模

Available for class 750 - 1/5th or 1/4th scale vehicles
 Number of stator slot: 12G 4P
 Sensored or sensorless: Sensorless
 Diameter of shaft: Φ 6mm- Φ 8mm
 Motor size: Diameter Φ 57 / Length 82~113mm
 Stator diameter: Φ 51.3mm
 Available winding: Delta/Star (Δ /Y)

Technique:

- Hand-wound for maximum copper fill.
- Precision-balanced rotor will boost the efficiency and power performance of the motor.
- Nickel-plated sintered neodymium rotor for maximum motor acceleration, braking power and performance in high-temperature conditions.

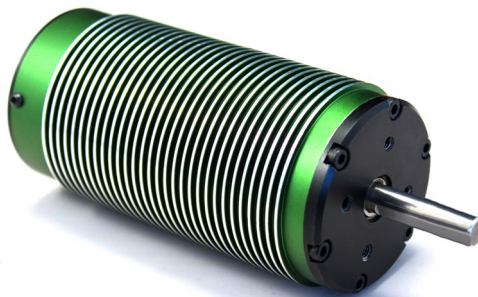

型号	KV (rpm/v)	最大电压	最大功率	最大电流	轴径x长度	马达尺寸	重量 (g)	安装孔尺寸 (mm)	螺丝孔深度
XTI-5782	1700	24V	4500W	180A	Φ 6xL20mm	Φ 55.8xL82mm	758g	Φ 30 4xM4	8mm
	1350	29V	4500W	152A	Φ 6xL20mm	Φ 55.8xL82mm	758g	Φ 30 4xM4	8mm
	1000	40V	4500W	110A	Φ 6xL20mm	Φ 55.8xL82mm	758g	Φ 30 4xM4	8mm
	900	43V	4500W	106A	Φ 6xL20mm	Φ 55.8xL82mm	758g	Φ 30 4xM4	8mm
XTI-5792	1350	29V	5500W	180A	Φ 6xL20mm	Φ 55.8xL92mm	880g	Φ 30 4xM4	8mm
	1100	35V	5500W	160A	Φ 6xL20mm	Φ 55.8xL92mm	880g	Φ 30 4xM4	8mm
	1000	40V	5500W	140A	Φ 6xL20mm	Φ 55.8xL92mm	880g	Φ 30 4xM4	8mm
	750	50V	5500W	110A	Φ 6xL20mm	Φ 55.8xL92mm	880g	Φ 30 4xM4	8mm
	550	74V	5500W	88A	Φ 6xL20mm	Φ 55.8xL92mm	880g	Φ 30 4xM4	8mm
XTI-5798	1100	36V	6500W	180A	Φ 6xL20mm	Φ 55.8xL98mm	1020g	Φ 30 4xM4	8mm
	900	38V	6500W	165A	Φ 6xL20mm	Φ 55.8xL98mm	1020g	Φ 30 4xM4	8mm
	850	48V	6500W	136A	Φ 8xL30mm	Φ 55.8xL98mm	1020g	Φ 30 4xM4	8mm
	600	58V	6500W	105A	Φ 8xL30mm	Φ 55.8xL98mm	1020g	Φ 30 4xM4	8mm
XTI-57113	1450	24V	7600W	300A	Φ 8xL30mm	Φ 55.8xL113mm	1160g	Φ 30 4xM4	8mm
	950	36V	7600W	210A	Φ 8xL30mm	Φ 55.8xL113mm	1160g	Φ 30 4xM4	8mm
	750	48V	7600W	158A	Φ 8xL30mm	Φ 55.8xL113mm	1160g	Φ 30 4xM4	8mm
	650	55V	7600W	140A	Φ 8xL30mm	Φ 55.8xL113mm	1160g	Φ 30 4xM4	8mm
	400	92V	7600W	82A	Φ 8xL30mm	Φ 55.8xL113mm	1160g	Φ 30 4xM4	8mm

